

Fruitland Road Right of Way Options

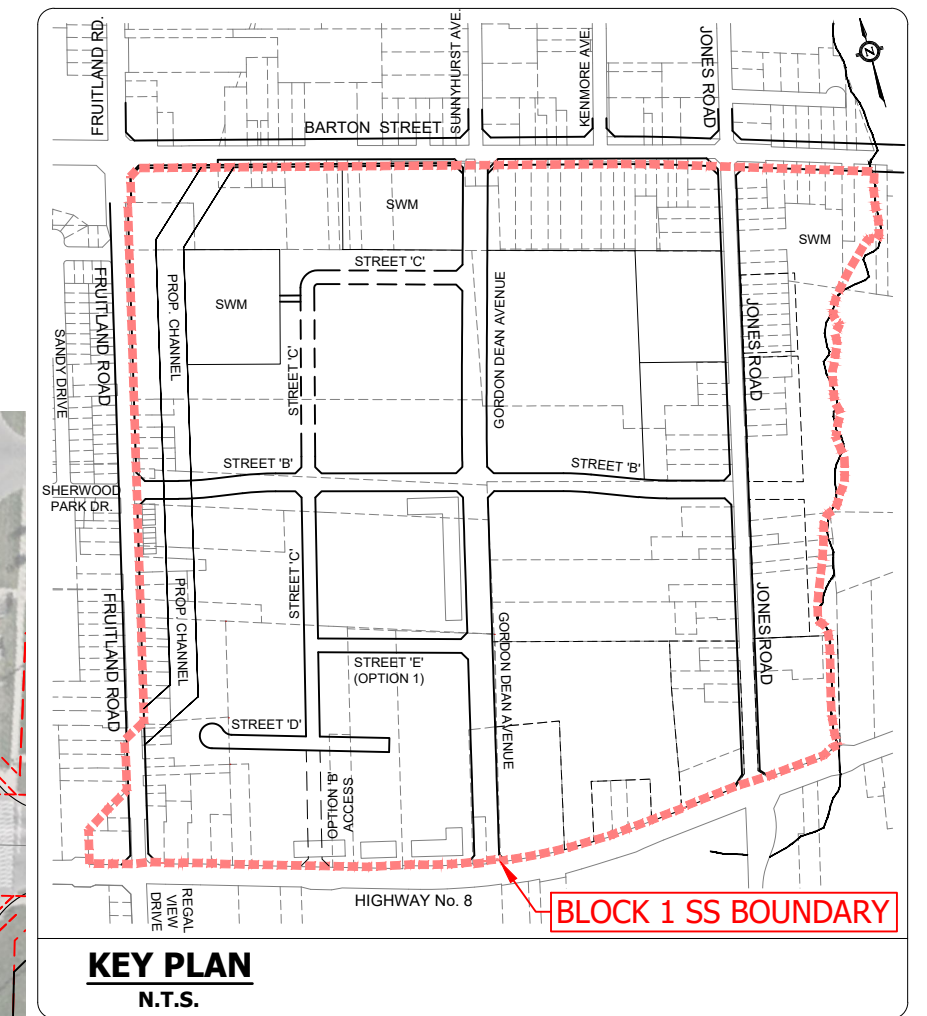
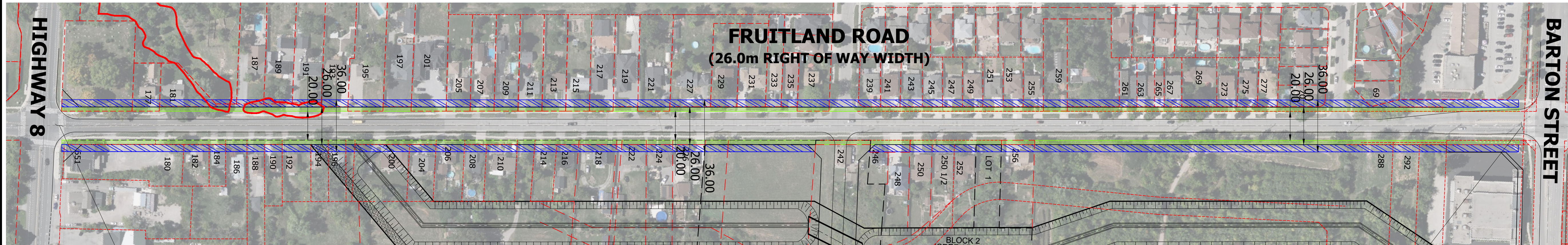
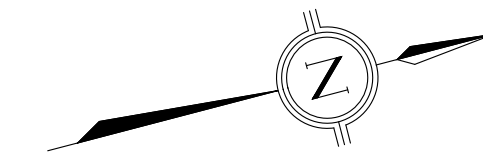

INTERSECTION DESIGN TO BE INCLUDED IN HIGHWAY 8 ENVIRONMENTAL ASSESSMENT BEING CONDUCTED BY THE CITY

INTERSECTION DESIGN TO BE INCLUDED IN BARTON STREET TO FIFTY ROAD ENVIRONMENTAL ASSESSMENT BEING CONDUCTED BY THE CITY

LEGEND

- LIMIT OF PROPERTY
- - - - - EXISTING LOT LINE
- █ PRIVATE LAND THAT MAY BE REQUIRED FOR 26m ROW
- █ PRIVATE LAND THAT MAY BE REQUIRED FOR 36m ROW

NOTE:
SOME DEDICATIONS HAVE ALREADY BEEN MADE AND ARE NOT REFLECTED ON THIS PLAN.

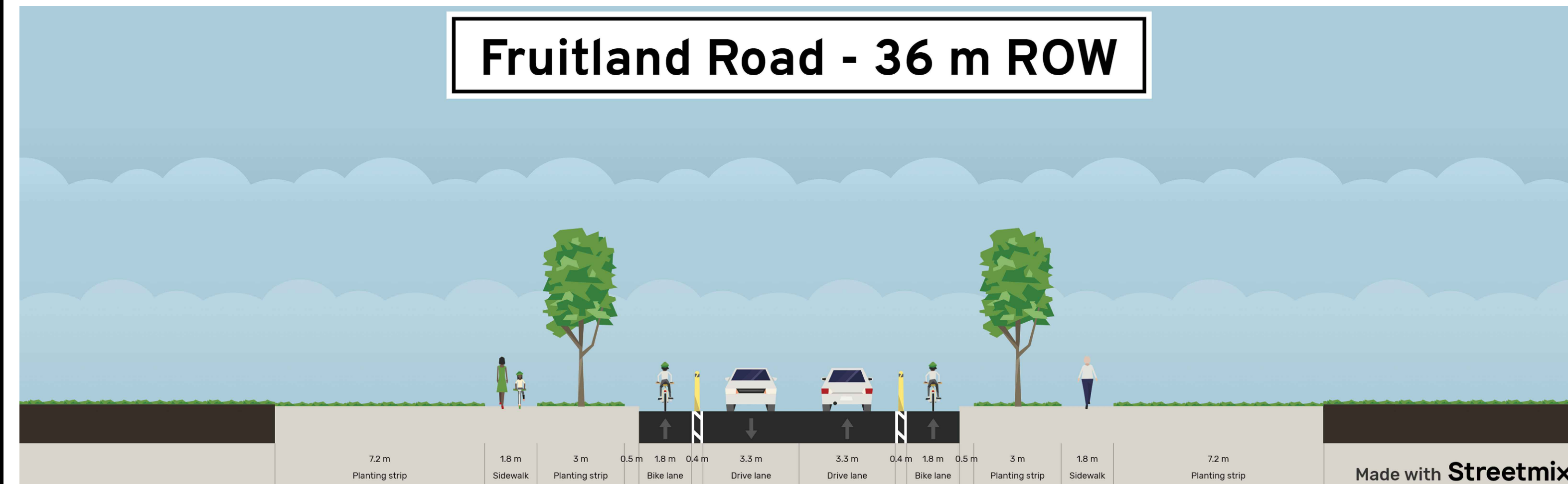
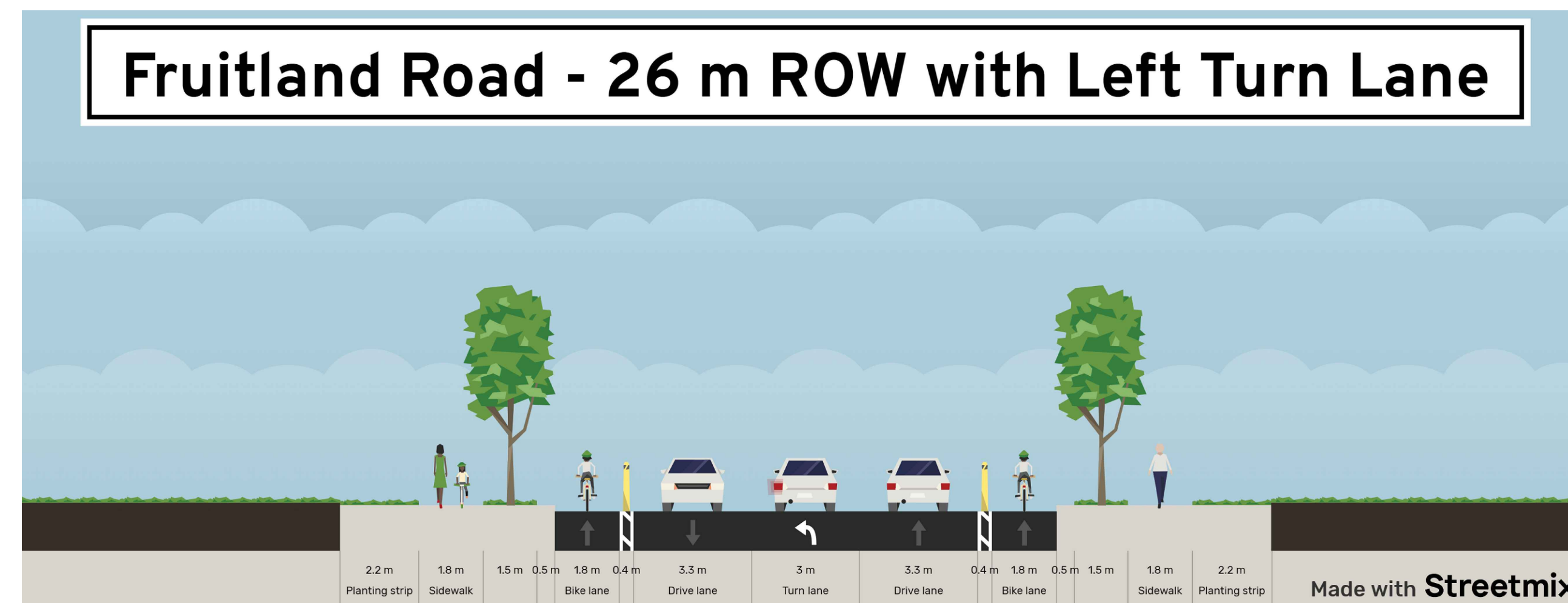
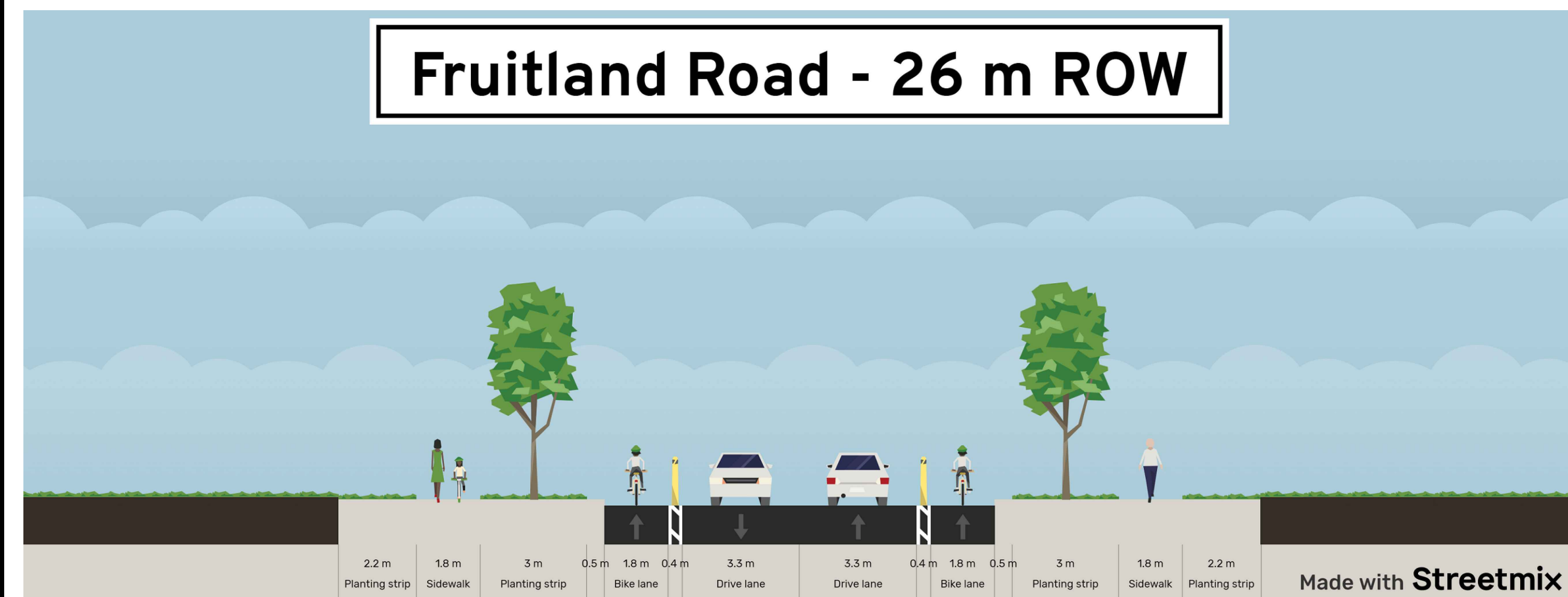

FRUITLAND ROAD IS CURRENTLY DESIGNATED AS A 36m WIDE ARTERIAL ROAD INTENDED TO CARRY LARGE VOLUMES OF TRAFFIC IN THE CITY OF HAMILTON'S OFFICIAL PLAN. THE CONSTRUCTION OF GORDON DEAN AVENUE IS INTENDED TO REPLACE FRUITLAND ROAD AS THE ARTERIAL ROAD IN THIS AREA.

WE PROPOSE CHANGING THE RIGHT OF WAY WIDTH OF FRUITLAND ROAD TO 26m. THE CURRENT RIGHT OF WAY WIDTH IS 26m FOR FRUITLAND ROAD NORTH OF BLOCK 1 AND 20m WIDE FOR REGAL VIEW SOUTH OF BLOCK 1.

THIS DIAGRAM ILLUSTRATES THE DIFFERENCE IN RIGHT OF WAY GEOMETRY AS WELL AS THE LAND REQUIRED FOR BOTH OPTIONS.

FRUITLAND ROAD SECTIONS PROVIDED BY PARADIGM TRANSPORTATION SOLUTIONS LIMITED

Urbantech® Consulting
A Division of Leighton-Zec West Ltd.
2030 Bristol Circle, Suite 105
Oakville, ON. L6H 0H2
TEL 905.829.8818 • urbantech.com

**BLOCK 1 SERVICING STRATEGY
CITY OF HAMILTON**

**FRUITLAND ROAD
RIGHT OF WAY
OPTIONS**

| PROJECT No. | DATE | SCALE | DWG No. |
|-------------|------------|--------|---------------|
| 20-263 | SEPT. 2023 | 1:1500 | PIC-10 |